

4K Management Products

EPHD series HDMI matrix is professional switcher routes UHD 4Kx2K HDMI signals to any outputs in need. It provides high peak data transfer rate and perfectly supports synchronous switching of HDMI signals, the robust industrial design makes it able to be a signal management center for high definition signal transmission. It can be widely used in command control center, multi-screen systems, conference room, high definition medical or education teaching etc.

MODEL: E-PHD44



MODEL: E-PHD88



MODEL: E-PHD1616



SPECIFICATION

Input Type	HDMI	Specification	Input/output support 16 channels
Output Type	HDMI	Input	HDMI
Video Protocol	HDMI 1.4, HDCP 1.4,	Output	HDMI
Maximum Resolution	Up to 4kx2k at 30Hz	Control Way	Front panel,RS-232,TCP/IP
HDMI Interface	Type A, 19 pin, female	Resolution	Up to 4k x 2k (4096×2160)
Serial Interface	RS-232 IN, DB9, Female; RS-232 OUT, DB9, Male	HDMI Version	HDMI 1.4, Support 3D TV
Input Cable Length	Adaptive equalizer for cable lengths up to 30 meters	HDCP	Compliant to HDCP 1.4
Output Cable Length	≤ 15m	Hot Plug	Support plug and play
RJ45 Control Protocol	TCP/IP	Input Cable	Up to 30m(98 feet)
Ethernet Rate	Self-adaptive 10M/100M	Output Cable	Up to 15m (50 feet)
Storage Environment	Temperature: -20°C ~ +70°C Humidity: 10%~90%	HDMI Input/Output Interface	Type A, 19 pin, female
Work Environment	Temperature: -20°C ~ +70°C Humidity: 10%~90%	Power Supply	110~220 VAC
Power Supply	AC 110~240V	Environment	Storage and Work Temperature: -20°~+70°C; Humidity:10%~90%
Maximum Power Dissipation	10W	Weight	7kg
Dimensions (WxDxH)	1U(436.8X280X44.5)mm	Consumption	20W
Weight	About 2.3kg	Dimension (WxDxH)	2U (440mm x 333mm x 88mm)
MTBF	30,000 hours		

MODEL E-HE10 (100m) / E-HE7 (70m)



E-HE10 (100m) / E-HE7 (70m)

The **E-HE10/7 HDMI Extender** over cat5e/cat6 is to extend the HDMI signal over long distances to a compatible display. It is designed to convert HDMI signal to standard HDBaseT signal and transmit by Cat5e/6 cable. It also transmit Bi-directional Infrared signal together with the HDMI signal, capable of controlling the source in the device side out to 100 meters, or from source to device, RS232 pass through makes it more convenient to be controlled.

MODEL E-HE-20

E-HE20 embedded wall panel transmitter using HDBaseT technology to transmit video, audio and control signals (can be used with the matrix), and HDBaseT series interface products are fully compatible. Support CVBS, YPbPr, VGA, DVI, HDMI signal transmission and IR, RS232 pass through function, DC 12V / 2A power supply and support POC power supply.

This product is mainly used in radio and television engineering, multimedia conference hall, TV teaching, command and control center and other occasions.



HDMI/VGA TO HDBASET WALLPLATE

MODEL E-VW4



MINI 4 PICTURE VIDEO WALL PROCESSOR

The **E-VW4** is designed to be performed as video wall processor, with its compact but versatile features, you can easily to realize video wall picture in many ways to manage the digital signal input, on the display like LCD, Plasma, TV etc.

The input signal types: HDMI, VGA, Composite video, moreover, the decoded video like RMVB, audio and Photos can be processed through USB. Output HDMI port to meet the most common interface on the display to support up to 1080P.

MODEL E-VW10

The **E-VW10** is designed to be performed as video wall processor, with its compact but versatile features, you can easily to realize video wall picture in many ways to manage the digital signal input, on the display like LCD, Plasma, TV etc.

The input signal types: HDMI, VGA, Composite video, moreover, the decoded video like RMVB, audio and Photos can be processed through USB. Output HDMI port to meet the most common interface on the display to support up to 1080P.



PICTURE VIDEO WALL PROCESSOR

APPLICATION CASES



ADDRESSING ROOM



TRAINING ROOM



MONITORING ROOM

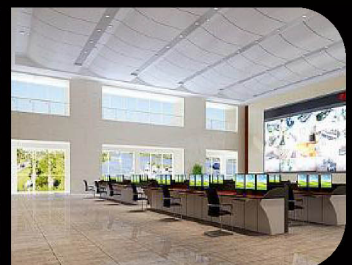

EDUCATION